



Merrybent,

Darlington, DL2 2LE

Offers in the region of £750,000

House - Detached
4 Bedroom/s
3 Bathroom/s

Welcome to this stunning detached home located in the picturesque linear village of Merrybent, just outside of the West End of Darlington. This charming, modernised property boasts 3 reception rooms, 4 bedrooms, and 3 bathrooms/shower rooms, offering ample space for comfortable living. As you step into this beautiful home, you are greeted by a sense of character and history, with period features adding to its unique charm. The property's large garden is a true gem, perfect for relaxing in the sunshine or hosting gatherings with friends and family. One of the highlights of this property is the breath-taking countryside views. For those who work from home, the home office located at the bottom of the garden provides a peaceful and productive space away from the main house. Whether you're looking to focus on work or indulge in a hobby, this separate office area offers versatility, comfort and convenience. In addition to the home office, this property also features a garage and plenty of parking. Don't miss this opportunity to own this stunning home in Merrybent, where countryside living meets modern comfort. Book a viewing today and experience the unique charm and potential that this period home has to offer.





- STUNNING DETACHED HOME
- OFF STREET PARKING AND GARAGE
- HIGHLY IMPRESSIVE KITCHEN
- LARGE REAR GARDEN
- HOME OFFICE AT THE BOTTOM OF THE GARDEN
- RENOVATED BATHROOM/SHOWER ROOMS

GENERAL INFORMATION:
 Tenure: Freehold
 Services: Oil central heating, mains electric, water and drainage.
 Double glazing
 Local Authority: Darlington Borough Council (Tax Banding F)









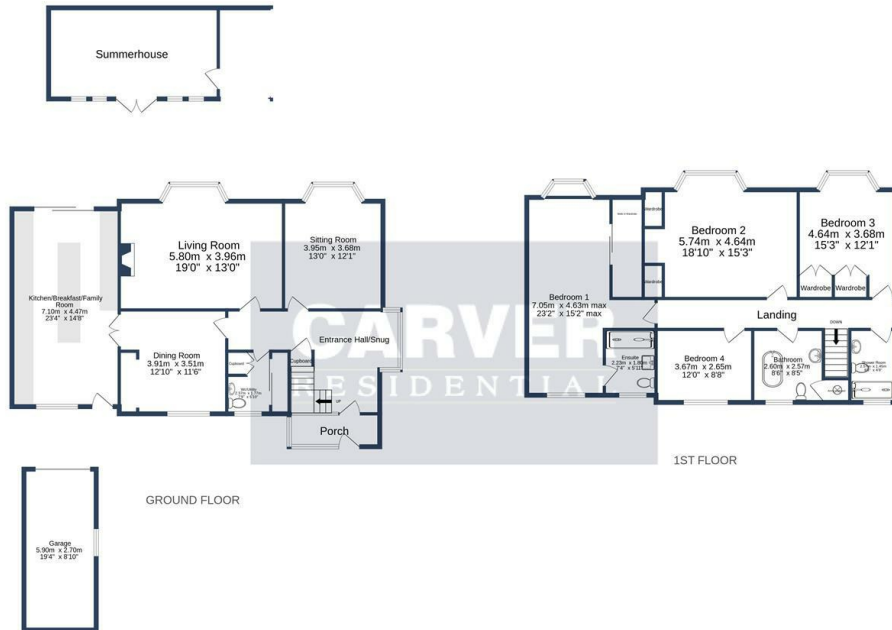
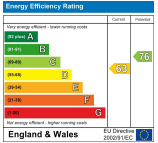

MERRYBENT, DARLINGTON, DL2 2LE.

Whilst every attempt has been made to ensure the accuracy of the floorplan contained here, measurements of doors, windows, rooms and any other items are approximate and no responsibility is taken for any error, omission or mis-statement. This plan is for illustrative purposes only and should be used as such by any prospective purchaser. The services, systems and appliances shown have not been tested and no guarantee as to their operability or efficiency can be given.
Made with Metropix ©2004

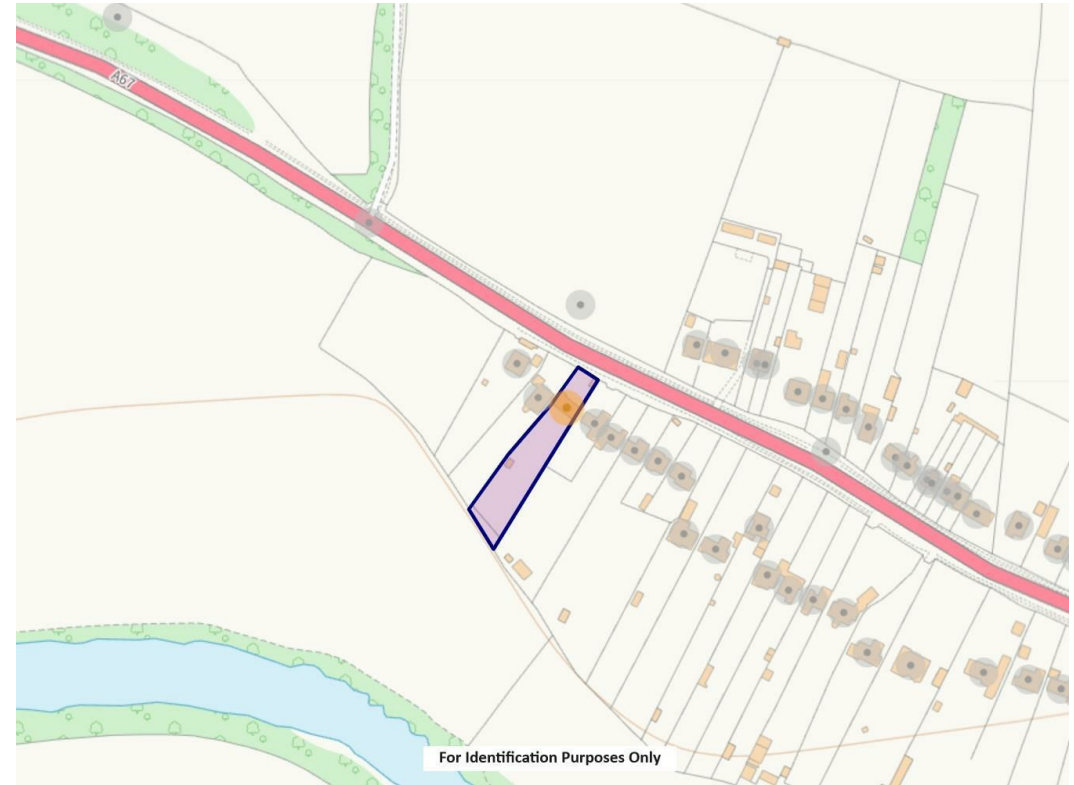

We can search 1,000s of mortgages for you

It could take just 15 minutes with one of our specialist advisers:
Call: 01325 380088. Visit: Any of our Offices. Online: www.mortgageadvicebureau.com/carver



Your home may be repossessed if you do not keep up repayments on your mortgage.
There will be a fee for mortgage advice. The actual amount you pay will depend upon your circumstances.
The fee is up to 1% but a typical fee is 0.3% of the amount borrowed

MAB 6202



These particulars do not constitute any part of an offer or contract. None of the statements contained in these particulars are to be relied on as statements or representations of fact and any intending purchaser must satisfy himself by inspection or otherwise to the correctness of each of the statements contained in these particulars. The vendor does not make or give, and neither Nick & Gordon Carver Residential or Commercial, Nick & Gordon Carver, nor any person in their employment has any authority to make or give any representation or warranty whatever in relation to this property



14 Duke Street, Darlington
County Durham, DL3 7AA
Tel: 01325 357807
sales@carvergroup.co.uk

26 Market Place, Richmond
North Yorkshire, DL10 4QG
Tel: 01748 825317
richmond@carvergroup.co.uk

43 Dalton Way, Newton Aycliffe
County Durham, DL5 4DJ
Tel: 01325 320676
aycliffe@carvergroup.co.uk

219 High Street, Northallerton
North Yorkshire, DL7 8LW
Tel: 01609 777710
northallerton@carvergroup.co.uk

www.carvergroup.co.uk