



**CARVER**  
RESIDENTIAL  
Sales · Lettings · Property Management

Belvedere Road  
Darlington, DL1 5EW  
**Price £110,000**

House - Terraced  
2 Bedroom/s  
1 Bathroom/s



Nestled on the charming Belvedere Road in Darlington, this impressive terraced house offers a delightful blend of character and modern convenience. This older-style home is deceptively spacious, providing a comfortable and inviting atmosphere that is ready for you to move into without delay.

Upon entering, you will find a welcoming hallway, two generously sized reception rooms, perfect for entertaining guests or enjoying quiet evenings at home. The refitted kitchen is equipped with essential cooking appliances, making meal preparation a pleasure. The property boasts two double bedrooms, ensuring ample space for relaxation and rest. The refitted bathroom, complete with a WC, adds a touch of modernity to this lovely home, also having useful shelving.

Step outside to discover an enclosed private courtyard, an ideal spot for enjoying the fresh air or hosting outdoor gatherings. The location is particularly advantageous, as it is within walking distance to the train station, providing excellent transport links, and the vibrant town centre, where you can explore a variety of shops, cafes, and amenities. Offered for sale with NO ONWARD CHAIN.





- NO ONWARD CHAIN
- POPULAR RESIDENTIAL LOCATION
- TWO WELL APPOINTED RECEPTION ROOMS
- TWO DOUBLE BEDROOMS
- COMBINATION BOILER REFITTED IN 2024

- IMPRESSIVE PROPERTY
- WALKING DISTANCE TO THE VIBRANT TOWN CENTER & MINUTES FROM THE TRAIN STATION
- REFITTED KITCHEN WITH INTEGRATED DISHWASHER
- FIRST FLOOR REFITTED BATHROOM/WC
- INTERNAL VIEWING WILL IMPRESS THE DISCERNING BUYER

#### GENERAL INFORMATION

Tenure: Freehold

Services: Gas central heating, refitted boiler mains electric, water and drainage.

Double glazing

Local Authority: Darlington Borough Council (Tax Banding A)



## Ground Floor

Approx. 44.2 sq. metres (475.8 sq. feet)

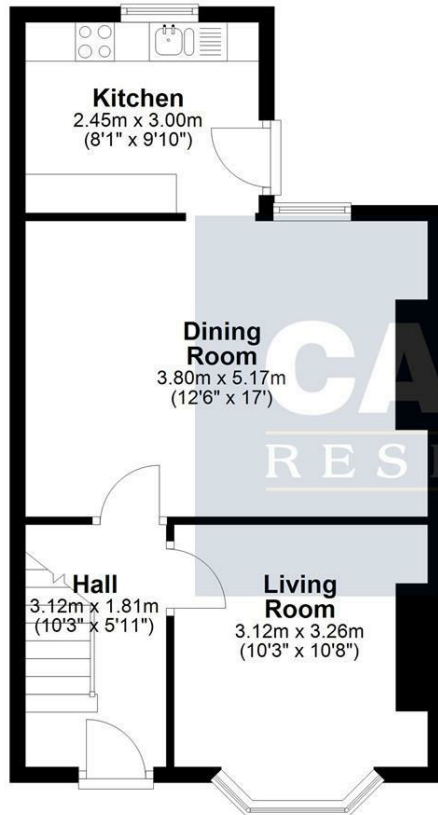

## First Floor

Approx. 35.7 sq. metres (384.4 sq. feet)

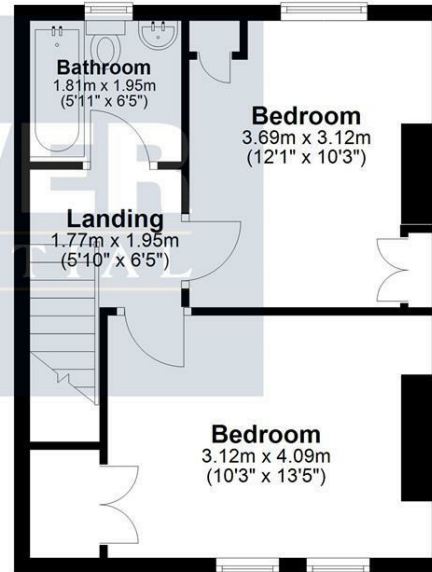

Total area: approx. 79.9 sq. metres (860.2 sq. feet)

41 Belvedere Road, Darlington

Energy Efficiency Rating		
	Current	Potential
Very energy efficient - lower running costs		
(92 plus) <b>A</b>		88
(81-91) <b>B</b>		
(69-80) <b>C</b>		
(55-68) <b>D</b>	70	
(39-54) <b>E</b>		
(21-38) <b>F</b>		
(1-20) <b>G</b>		
Not energy efficient - higher running costs		
England & Wales		EU Directive 2002/91/EC

We can search 1,000s of mortgages for you

It could take just 15 minutes with one of our specialist advisers:  
Call: 01325 380088. Visit: Any of our Offices. Online: [www.mortgageadvicebureau.com/carver](http://www.mortgageadvicebureau.com/carver)



Your home may be repossessed if you do not keep up repayments on your mortgage.  
There will be a fee for mortgage advice. The actual amount you pay will depend upon your circumstances.  
The fee is up to 1% but a typical fee is 0.3% of the amount borrowed

MAB 6202



These particulars do not constitute any part of an offer or contract. None of the statements contained in these particulars are to be relied on as statements or representations of fact and any intending purchaser must satisfy himself by inspection or otherwise to the correctness of each of the statements contained in these particulars. The vendor does not make or give, and neither Nick & Gordon Carver Residential or Commercial, Nick & Gordon Carver, nor any person in their employment has any authority to make or give any representation or warranty whatever in relation to this property



14 Duke Street, Darlington  
Co Durham, DL3 7AA  
01325 357807  
[sales@carvergroup.co.uk](mailto:sales@carvergroup.co.uk)

63 Dalton Way, Newton Aycliffe  
Co Durham DL5 4NB  
01325 320676  
[aycliffe@carvergroup.co.uk](mailto:aycliffe@carvergroup.co.uk)

41 Market Place, Richmond  
North Yorkshire, DL10 4QL  
01748 825317  
[richmond@carvergroup.co.uk](mailto:richmond@carvergroup.co.uk)

219 High Street, Northallerton  
North Yorkshire DL7 8LW  
01609 777710  
[northallerton@carvergroup.co.uk](mailto:northallerton@carvergroup.co.uk)

[www.carvergroup.co.uk](http://www.carvergroup.co.uk)