





Tucked away within the cul-de-sac off Westfield Drive, Darlington, this stunning detached house offers a perfect blend of charm and modern living. The property has been finished to an exceptional standard, making it a delightful home for families and individuals alike. Boasting four generously sized bedrooms, including a main bedroom with an ensuite shower room, this residence provides ample space for relaxation and privacy. The two well-appointed reception rooms are ideal for entertaining guests or enjoying quiet family evenings, ensuring that every corner of the home is both functional and inviting. Set on a larger corner plot, the property features a spacious garden that offers a wonderful outdoor space for children to play, gardening enthusiasts to thrive, or simply for enjoying the fresh air. The garden is a perfect canvas for those who appreciate outdoor living and wish to create their own personal oasis. Conveniently located, this home provides easy access to excellent local schools, making it an ideal choice for families seeking quality education for their children. The surrounding area is peaceful yet well-connected, ensuring that all necessary amenities are within reach. In summary, this exceptional detached house on Westfield Drive is a rare find, combining spacious living, a beautiful garden, and a prime location. It is a perfect opportunity for those looking to settle in a welcoming community while enjoying the comforts of a beautifully finished home.







- OFF STREET PARKING
- LARGE CORNER PLOT
- IDEALLY PLACED FOR SCHOOLS
- NEW COMBI BOILER FITTED 2023

- GARAGE
- SPACIOUS HOME
- POPULAR WEST END LOCATION

#### GENERAL INFORMATION:

Tenure: Freehold

Services: Gas central heating, mains electric, water and drainage.

Double glazing

Local Authority: Darlington Borough Council (Tax Banding E)



















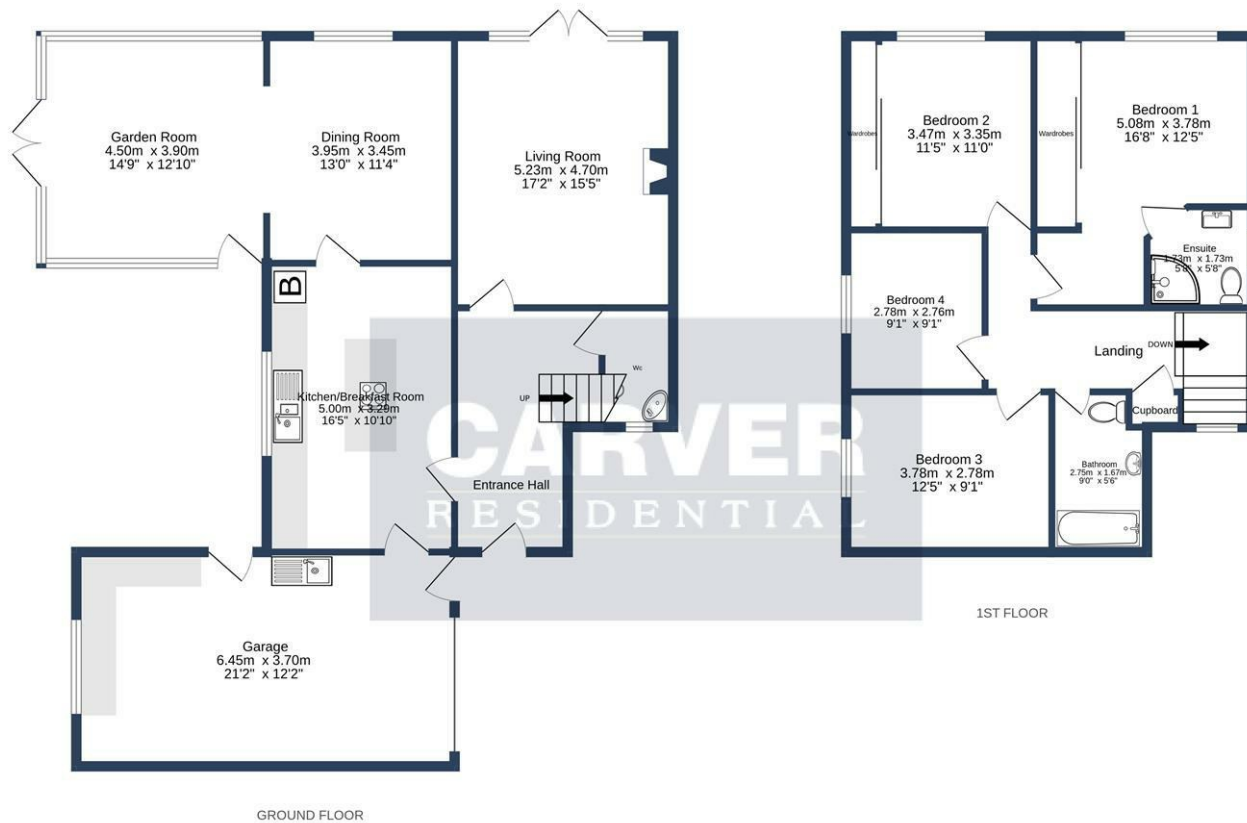

WESTFIELD DRIVE, DARLINGTON, DL3 9BB.

Whilst every attempt has been made to ensure the accuracy of the floorplan contained here, measurements of doors, windows, rooms and any other items are approximate and no responsibility is taken for any error, omission or mis-statement. This plan is for illustrative purposes only and should be used as such by any prospective purchaser. The services, systems and appliances shown have not been tested and no guarantee as to their operability or efficiency can be given.  
Made with Metropix ©2025

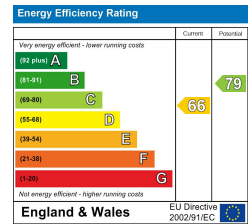

**We can search 1,000s of mortgages for you**

It could take just 15 minutes with one of our specialist advisers:  
Call: 01325 380088. Visit: Any of our Offices. Online: [www.mortgageadvicebureau.com/carver](http://www.mortgageadvicebureau.com/carver)



Your home may be repossessed if you do not keep up repayments on your mortgage.  
There will be a fee for mortgage advice. The actual amount you pay will depend upon your circumstances.  
The fee is up to 1% but a typical fee is 0.3% of the amount borrowed

MAB 6202



These particulars do not constitute any part of an offer or contract. None of the statements contained in these particulars are to be relied on as statements or representations of fact and any intending purchaser must satisfy himself by inspection or otherwise to the correctness of each of the statements contained in these particulars. The vendor does not make or give, and neither Nick & Gordon Carver Residential or Commercial, Nick & Gordon Carver, nor any person in their employment has any authority to make or give any representation or warranty whatever in relation to this property

**naea**  
**propertymark**

**PROTECTED**



**14 Duke Street, Darlington**  
**Co Durham, DL3 7AA**  
**01325 357807**  
**sales@carvergroup.co.uk**

**63 Dalton Way, Newton Aycliffe**  
**Co Durham DL5 4NB**  
**01325 320676**  
**aycliffe@carvergroup.co.uk**

**41 Market Place, Richmond**  
**North Yorkshire, DL10 4QL**  
**01748 825317**  
**richmond@carvergroup.co.uk**

**219 High Street, Northallerton**  
**North Yorkshire DL7 8LW**  
**01609 777710**  
**northallerton@carvergroup.co.uk**

**[www.carvergroup.co.uk](http://www.carvergroup.co.uk)**