



A beautifully presented two bedroomed period terraced cottage situated close to the village of Danby Wiske and within easy reach of Northallerton. The property benefits from oil fired central heating and Upvc double glazing. The accommodation includes an entrance hall, spacious living room with log burning stove and useful understairs storage cupboard, fitted kitchen / dining room with integrated oven and hob and period style range. To the first floor there are two double bedrooms and a family bathroom. The attic has been boarded and is accessed via a ladder. Externally there is front garden with gravel seating area and to the rear a stone flagged patio and slate area.





- Two double bedroomed mid terraced period cottage
- Fitted kitchen / dining room
- Family bathroom including shower cubicle
- Rear stone flagged patio area
- Close to the village of Danby Wiske
- Spacious living room with log burning stove
- Two double bedrooms
- Front garden with gravel seating area
- Oil fired central heating and Upvc double glazing

GENERAL INFORMATION

Tenure: Freehold

Services: Oil central heating, mains electric, water and drainage to a septic tank.

Double glazing.

Local Authority: North Yorkshire Band A

The current owner pays £1046.28 per annum to rent a parking space for two cars and additional front garden from Network Rail.

Note - The property is situated close to the main railway line.

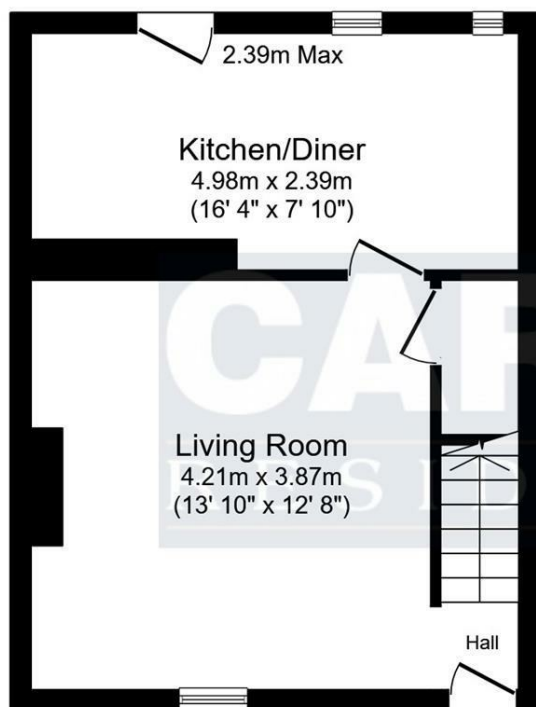

Ground Floor

Floor area 33.6 sq.m. (362 sq.ft.)

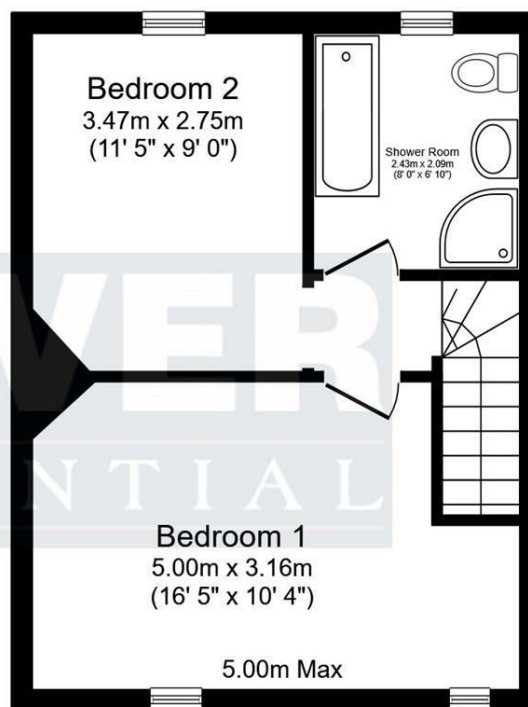

First Floor

Floor area 33.7 sq.m. (362 sq.ft.)

TOTAL: 67.3 sq.m. (724 sq.ft.)

This floor plan is for illustrative purposes only. It is not drawn to scale. Any measurements, floor areas (including any total floor area), openings and orientations are approximate. No details are guaranteed, they cannot be relied upon for any purpose and do not form any part of any agreement. No liability is taken for any error, omission or misstatement. A party must rely upon its own inspection(s). Powered by www.Propertybox.io

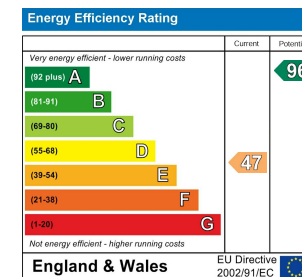

We can search 1,000s of mortgages for you

It could take just 15 minutes with one of our specialist advisers:
Call: 01325 380088. Visit: Any of our Offices. Online: www.mortgageadvicebureau.com/carver



Your home may be repossessed if you do not keep up repayments on your mortgage. There will be a fee for mortgage advice. The actual amount you pay will depend upon your circumstances. The fee is up to 1% but a typical fee is 0.3% of the amount borrowed

MAB 6202



These particulars do not constitute any part of an offer or contract. None of the statements contained in these particulars are to be relied on as statements or representations of fact and any intending purchaser must satisfy himself by inspection or otherwise to the correctness of each of the statements contained in these particulars. The vendor does not make or give, and neither Nick & Gordon Carver Residential or Commercial, Nick & Gordon Carver, nor any person in their employment has any authority to make or give any representation or warranty whatever in relation to this property



14 Duke Street, Darlington
County Durham, DL3 7AA
Tel: 01325 357807
sales@carvergroup.co.uk

26 Market Place, Richmond
North Yorkshire, DL10 4QG
Tel: 01748 825317
richmond@carvergroup.co.uk

43 Dalton Way, Newton Aycliffe
County Durham, DL5 4DJ
Tel: 01325 320676
aycliffe@carvergroup.co.uk

219 High Street, Northallerton
North Yorkshire, DL7 8LW
Tel: 01609 777710
northallerton@carvergroup.co.uk

www.carvergroup.co.uk