





Nestled in the charming village of Low Etherley, this delightful cottage presents an excellent opportunity for those seeking a ready-to-move-in home. With no onward chain, this property is ideal for first-time buyers or those looking to downsize.

Upon entering, you are welcomed into a spacious living room that exudes warmth and comfort, perfect for relaxing or entertaining guests. The fitted kitchen/diner is both practical and inviting, providing ample space for family meals and gatherings. The first floor boasts two generously sized double bedrooms, ensuring plenty of room for rest and relaxation. The contemporary bathroom features a modern suite, adding a touch of elegance to your daily routine.

Externally, the property benefits from an enclosed rear courtyard, offering a private outdoor space for enjoying the fresh air or hosting summer barbecues. The picturesque surroundings of Low Etherley enhance the appeal of this home, with easy access to the amenities of nearby Bishop Auckland.

This cottage is not just a house; it is a place where memories can be made. With its blend of comfort, style, and convenience, it is a must-see for anyone looking to settle in this lovely village.







- POPULAR VILLAGE LOCATION
- SUITED TO A VARIETY OF BUYERS
- WELL PLACED FOR EASE OF ACCESS TO BISHOP AUCKLAND & SURROUNDING AREAS
- NEWLY CARPETED
- COMPETITIVELY PRICED TO REFLECT AN EARLY SALE
- READY TO MOVE INTO
- NO ONWARD CHAIN
- FITTED KITCHEN
- TWO DOUBLE BEDROOMS

#### GENERAL INFORMATION

Tenure: Freehold

Services: gas central heating, mains electric, water and drainage.

Double glazing

Local Authority: Durham County Council (Tax Banding A)

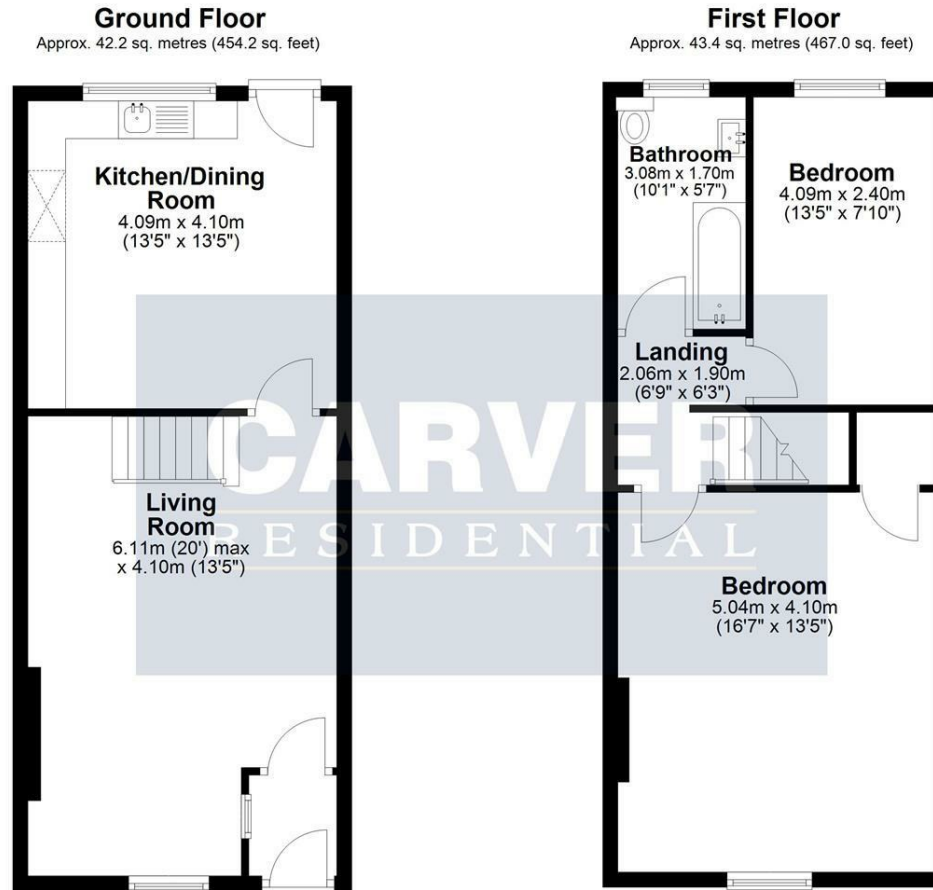

Total area: approx. 85.6 sq. metres (921.2 sq. feet)  
**24 Low Etherley, BISHOP AUCKLAND**

**We can search 1,000s of mortgages for you**

It could take just 15 minutes with one of our specialist advisers:  
 Call: 01325 380088. Visit: Any of our Offices. Online: [www.mortgageadvicebureau.com/carver](http://www.mortgageadvicebureau.com/carver)



Your home may be repossessed if you do not keep up repayments on your mortgage.  
 There will be a fee for mortgage advice. The actual amount you pay will depend upon your circumstances.  
 The fee is up to 1% but a typical fee is 0.3% of the amount borrowed

MAB 6202



These particulars do not constitute any part of an offer or contract. None of the statements contained in these particulars are to be relied on as statements or representations of fact and any intending purchaser must satisfy himself by inspection or otherwise to the correctness of each of the statements contained in these particulars. The vendor does not make or give, and neither Nick & Gordon Carver Residential or Commercial, Nick & Gordon Carver, nor any person in their employment has any authority to make or give any representation or warranty whatever in relation to this property



**14 Duke Street, Darlington**  
 Co Durham, DL3 7AA  
 01325 357807  
[sales@carvergroup.co.uk](mailto:sales@carvergroup.co.uk)

**63 Dalton Way, Newton Aycliffe**  
 Co Durham DL5 4NB  
 01325 320676  
[aycliffe@carvergroup.co.uk](mailto:aycliffe@carvergroup.co.uk)

**41 Market Place, Richmond**  
 North Yorkshire, DL10 4QL  
 01748 825317  
[richmond@carvergroup.co.uk](mailto:richmond@carvergroup.co.uk)

**219 High Street, Northallerton**  
 North Yorkshire DL7 8LW  
 01609 777710  
[northallerton@carvergroup.co.uk](mailto:northallerton@carvergroup.co.uk)