



**CARVER**  
**RESIDENTIAL**  
Sales · Lettings · Property Management

St. Andrews Court  
Newton Aycliffe, DL5 4XA

**Offers in the region of £300,000**

Bungalow - Detached  
3 Bedroom/s  
1 Bathroom/s



Superbly positioned in a desirable cul-de-sac location, where homes seldom become available, this DETACHED BUNGALOW features a spacious living/dining room, perfect for both relaxation and entertaining. The recently installed kitchen is a delightful addition, providing a contemporary space for culinary pursuits, while the sun room invites natural light and offers a tranquil spot to unwind.

The bungalow boasts three generously sized bedrooms, ensuring ample space for family or guests. The family bathroom/WC is well-appointed, catering to all your needs. Recent upgrades, including uPVC double glazed windows, enhance energy efficiency and comfort throughout the home.

For those with vehicles, the property offers parking for up to six cars, with a four-car driveway leading to a DETACHED DOUBLE GARAGE. An additional driveway with gated access provides secure parking, adding to the convenience of this splendid home. The attractive enclosed rear garden is a perfect retreat, ideal for outdoor gatherings or simply enjoying the fresh air.

With its proximity to Woodham Golf Club and the peaceful surroundings of the cul-de-sac, this bungalow is not just a home; it is a lifestyle choice. Whether you are looking to downsize or seeking a family residence, this property is sure to impress. Do not miss the chance to make this delightful bungalow your own.







### Agents Notes

Tenure:- Freehold

Mains gas, (central heating to radiators), electricity & drainage

uPVC double glazed windows throughout

Council Tax:- Band D

Local Authority:- Durham County Council



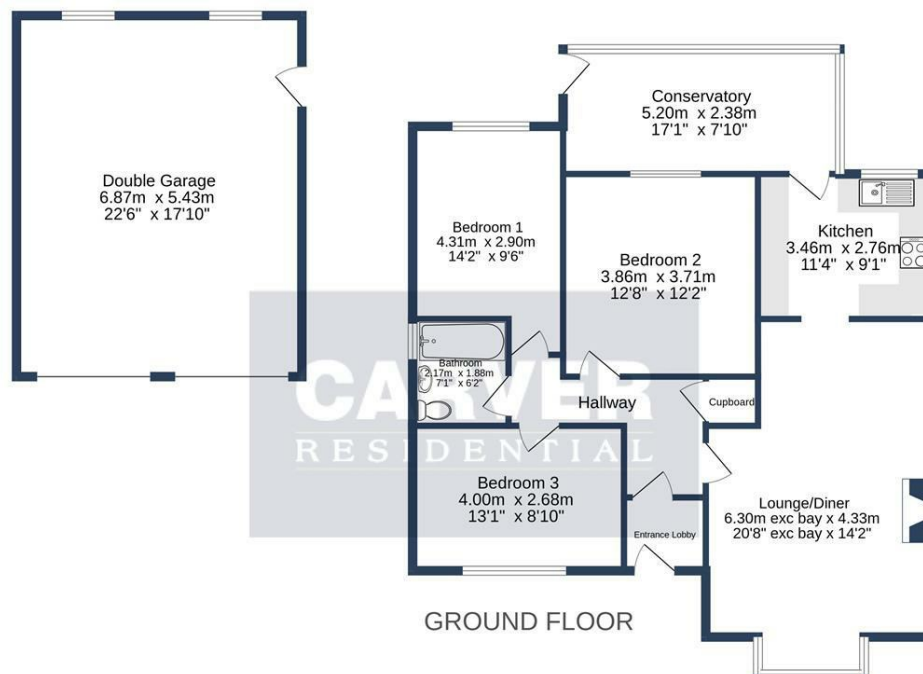

ST ANDREWS COURT, NEWTON AYCLIFFE, DL5 4XA.

Whilst every attempt has been made to ensure the accuracy of the floorplan contained here, measurements of doors, windows, rooms and any other items are approximate and no responsibility is taken for any error, omission or mis-statement. This plan is for illustrative purposes only and should be used as such by any prospective purchaser. The services, systems and appliances shown have not been tested and no guarantee as to their operability or efficiency can be given.  
Made with Metropix ©2025

Energy Efficiency Rating		Current	Potential
Very energy efficient - lower running costs			
(92 plus)	A		86
(81-91)	B		
(69-80)	C	71	
(55-68)	D		
(39-54)	E		
(21-38)	F		
(1-20)	G		
Not energy efficient - higher running costs			
England & Wales		EU Directive 2002/91/EC	

We can search 1,000s of mortgages for you

It could take just 15 minutes with one of our specialist advisers:  
Call: 01325 380088. Visit: Any of our Offices. Online: [www.mortgageadvicebureau.com/carver](http://www.mortgageadvicebureau.com/carver)



Your home may be repossessed if you do not keep up repayments on your mortgage.  
There will be a fee for mortgage advice. The actual amount you pay will depend upon your circumstances.  
The fee is up to 1% but a typical fee is 0.3% of the amount borrowed

MAB 6202



These particulars do not constitute any part of an offer or contract. None of the statements contained in these particulars are to be relied on as statements or representations of fact and any intending purchaser must satisfy himself by inspection or otherwise to the correctness of each of the statements contained in these particulars. The vendor does not make or give, and neither Nick & Gordon Carver Residential or Commercial, Nick & Gordon Carver, nor any person in their employment has any authority to make or give any representation or warranty whatever in relation to this property



14 Duke Street, Darlington  
Co Durham, DL3 7AA  
01325 357807  
[sales@carvergroup.co.uk](mailto:sales@carvergroup.co.uk)

63 Dalton Way, Newton Aycliffe  
Co Durham DL5 4NB  
01325 320676  
[aycliffe@carvergroup.co.uk](mailto:aycliffe@carvergroup.co.uk)

41 Market Place, Richmond  
North Yorkshire, DL10 4QL  
01748 825317  
[richmond@carvergroup.co.uk](mailto:richmond@carvergroup.co.uk)

219 High Street, Northallerton  
North Yorkshire DL7 8LW  
01609 777710  
[northallerton@carvergroup.co.uk](mailto:northallerton@carvergroup.co.uk)

[www.carvergroup.co.uk](http://www.carvergroup.co.uk)