



CARVER
RESIDENTIAL
Sales · Lettings · Property Management

Colorado Grove
Darlington, DL1 2YW

Offers in the region of £180,000

Bungalow - Semi Detached
2 Bedroom/s
1 Bathroom/s

Situated within this highly desirable Colorado Grove, Darlington, this modern two-bedroom semi-detached bungalow is a delightful find for those seeking a modern and comfortable home. Tucked away in a small cul-de-sac, the property offers a peaceful retreat while still being conveniently located.

Having been lovingly maintained by its sole owner since new, this bungalow is ready for you to move in without delay. The spacious living room provides a welcoming atmosphere, perfect for relaxation or entertaining guests. The recently refitted kitchen boasts integrated appliances, making it both stylish and functional for your culinary needs.

Two good sized bedrooms, master having built-in wardrobes, ensuring ample storage space. The modern bathroom/wc with overhead shower, adds to the convenience of this well-appointed bungalow.

Externally, the property benefits from a driveway and a garage, providing secure parking and additional storage options. The mature and established gardens at both the front and rear of the bungalow offer a lovely outdoor space to enjoy, whether for gardening or simply unwinding in the fresh air.

With no onward chain, this property presents an excellent opportunity for buyers looking for a seamless transition into their new home. This bungalow is not just a house; it is a place where you can create lasting memories. Don't miss the chance to make it yours.





- NO ONWARD CHAIN
- ONE OWNER FROM NEW
- REFITTED QUALITY KITCHEN WITH INTEGRATED APPLIANCES
- LARGE DRIVEWAY LEADING TO GARAGE
- BUNGALOWS ARE ALWAYS IN DEMAND

- CUL-DE-SAC LOCATION
- SPACIOUS INTERIOR
- TWO BEDROOMS
- BUS STOP & AMENITIES WITHIN WALKING DISTANCE

GENERAL INFORMATION

Tenure: Freehold

Services: Gas central heating, mains electric, water and drainage.

Double glazing

Local Authority: Darlington Borough Council (Tax Banding B)

Ground Floor

Approx. 48.3 sq. metres (520.0 sq. feet)

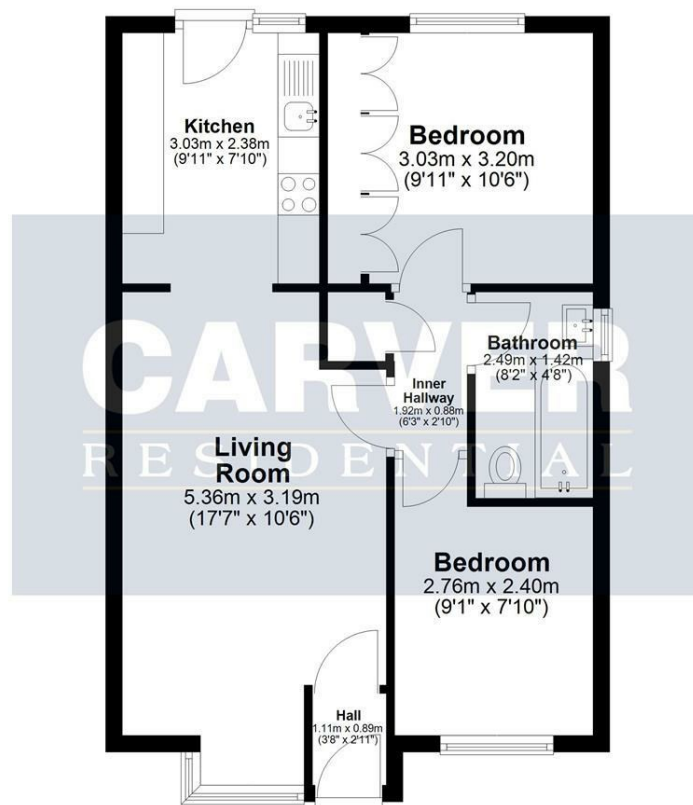

Total area: approx. 48.3 sq. metres (520.0 sq. feet)

30 Colorado Grove, Darlington

Energy Efficiency Rating		
	Current	Potential
Very energy efficient - lower running costs		
(92 plus) A		
(81-91) B		
(69-80) C		
(55-68) D		
(39-54) E		
(21-38) F		
(1-20) G		
Not energy efficient - higher running costs		
England & Wales	EU Directive 2002/91/EC	

We can search 1,000s of mortgages for you

It could take just 15 minutes with one of our specialist advisers:
Call: 01325 380088. Visit: Any of our Offices. Online: www.mortgageadvicebureau.com/carver



Your home may be repossessed if you do not keep up repayments on your mortgage.
There will be a fee for mortgage advice. The actual amount you pay will depend upon your circumstances.
The fee is up to 1% but a typical fee is 0.3% of the amount borrowed

MAB 6202



These particulars do not constitute any part of an offer or contract. None of the statements contained in these particulars are to be relied on as statements or representations of fact and any intending purchaser must satisfy himself by inspection or otherwise to the correctness of each of the statements contained in these particulars. The vendor does not make or give, and neither Nick & Gordon Carver Residential or Commercial, Nick & Gordon Carver, nor any person in their employment has any authority to make or give any representation or warranty whatever in relation to this property



14 Duke Street, Darlington
Co Durham, DL3 7AA
01325 357807
sales@carvergroup.co.uk

63 Dalton Way, Newton Aycliffe
Co Durham DL5 4NB
01325 320676
aycliffe@carvergroup.co.uk

41 Market Place, Richmond
North Yorkshire, DL10 4QL
01748 825317
richmond@carvergroup.co.uk

219 High Street, Northallerton
North Yorkshire DL7 8LW
01609 777710
northallerton@carvergroup.co.uk

www.carvergroup.co.uk