



**CARVER**  
RESIDENTIAL  
Sales · Lettings · Property Management

Elton Road  
Darlington, DL3 8LU

**Asking price £355,000**

House - Semi-Detached  
3 Bedroom/s  
1 Bathroom/s

A large three bedroom semi-detached period home located within the heart of the West End of Darlington, this is a property not to be missed. Occupying a larger than average plot with stunning gardens to the front and rear. The internal layout briefly comprises entrance hallway, two spacious reception rooms and modern kitchen with stunning views over the impeccably landscaped rear garden. To the first floor the landing gives access to three bedrooms, bathroom and separate WC. The property also benefits from off street parking, alongside the beautiful front garden, which gives access via double gates to the single garage beyond (with limited vehicular access). Gas central heating and UPVC double glazing is present throughout, as expected. EPC rating D, Darlington Borough Council tax band D.





- Period Semi Detached Home
- West End Location
- Tree Lined Street
- Wonderful Gardens
- Excellent Access to Schools and Town Centre
- Period and Modern Features Throughout

#### GENERAL INFORMATION

Tenure: Freehold

Services: Gas central heating, mains electric, water and drainage.

Double glazing

Local Authority: Darlington Borough Council (Tax Banding D)

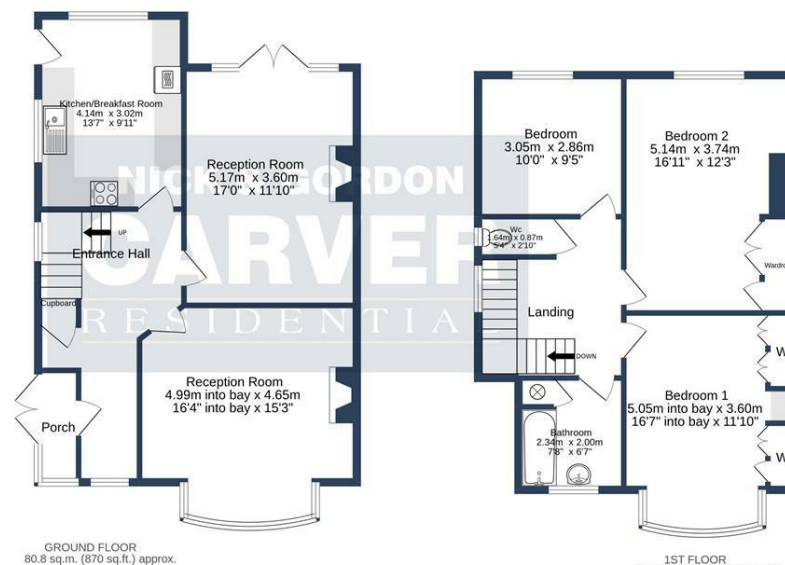

ELTON ROAD, DARLINGTON, DL3 8LU.

TOTAL FLOOR AREA: 142.1 sq.m. (1530 sq.ft.) approx.

Whilst every attempt has been made to ensure the accuracy of the floorplan contained here, measurements of doors, windows, rooms and any other items are approximate and no responsibility is taken for any error, omission or mis-statement. This plan is for illustrative purposes only and should be used as such by any prospective purchaser. The services, systems and appliances shown have not been tested and no guarantee as to their operability or efficiency can be given.  
Made with Metropix ©2022

Energy Efficiency Rating		
	Current	Potential
Very energy efficient - lower running costs		
(92 plus) <b>A</b>		<b>81</b>
(81-91) <b>B</b>		
(69-80) <b>C</b>		
(55-68) <b>D</b>	<b>63</b>	
(39-54) <b>E</b>		
(21-38) <b>F</b>		
(1-20) <b>G</b>		
Not energy efficient - higher running costs		
England & Wales		EU Directive 2002/91/EC

**We can search 1,000s of mortgages for you**

It could take just 15 minutes with one of our specialist advisers:  
Call: 01325 380088. Visit: Any of our Offices. Online: [www.mortgageadvicebureau.com/carver](http://www.mortgageadvicebureau.com/carver)



Your home may be repossessed if you do not keep up repayments on your mortgage.  
There will be a fee for mortgage advice. The actual amount you pay will depend upon your circumstances.  
The fee is up to 1% but a typical fee is 0.3% of the amount borrowed

MAB 6202



These particulars do not constitute any part of an offer or contract. None of the statements contained in these particulars are to be relied on as statements or representations of fact and any intending purchaser must satisfy himself by inspection or otherwise to the correctness of each of the statements contained in these particulars. The vendor does not make or give, and neither Nick & Gordon Carver Residential or Commercial, Nick & Gordon Carver, nor any person in their employment has any authority to make or give any representation or warranty whatever in relation to this property



**14 Duke Street, Darlington**  
Co Durham, DL3 7AA  
01325 357807  
[sales@carvergroup.co.uk](mailto:sales@carvergroup.co.uk)

**63 Dalton Way, Newton Aycliffe**  
Co Durham DL5 4NB  
01325 320676  
[aycliffe@carvergroup.co.uk](mailto:aycliffe@carvergroup.co.uk)

**41 Market Place, Richmond**  
North Yorkshire, DL10 4QL  
01748 825317  
[richmond@carvergroup.co.uk](mailto:richmond@carvergroup.co.uk)

**219 High Street, Northallerton**  
North Yorkshire DL7 8LW  
01609 777710  
[northallerton@carvergroup.co.uk](mailto:northallerton@carvergroup.co.uk)

[www.carvergroup.co.uk](http://www.carvergroup.co.uk)